

1
2
3
4
5
6
7
8
9
10
11
12

**BEFORE THE ARIZONA POWER PLANT
AND TRANSMISSION LINE SITING COMMITTEE**

In the matter of the application of Salt River Project Agricultural Improvement and Power District, in conformance with the requirements of Arizona Revised Statutes § 40-360, et seq., for a Certificate of Environmental Compatibility authorizing the South Mountain Transmission Project, which includes the construction of two new 230 kV double-circuit transmission lines that will interconnect the existing double-circuit Anderson-Orme transmission line to a new substation, each located within the city of Phoenix, Maricopa County, Arizona.

Docket No.
L-00000B-24-0223-00239

Case No. 239

NOTICE OF ERRATA

13
14
15
16
17
18
19
20
21
22
23
24

Adam Stafford, designee of the Attorney General of Arizona, Kristin Mayes, as Chairman and Presiding Officer of the Arizona Power Plant and Transmission Line Siting Committee, hereby files this Notice of Errata regarding the Certificate of Environmental Compatibility (“CEC”) filed in this matter on November 22, 2024.

The CEC included the incorrect map of the project identified as “Exhibit A”.

The correct Exhibit A as approved by the Committee is attached hereto.

DATED this 26th day of November, 2024.



25
26
27
28

Adam Stafford
Assistant Attorney General
Chairman, Arizona Power Plant and
Transmission Line Siting Committee
15 South 15th Avenue
Phoenix, Arizona 85007
Adam.Stafford@azag.gov

CERTIFICATION OF MAILING

ORIGINAL of the foregoing was e-filed this 26th day of November, 2024, with:

Utilities Division – Docket Control
ARIZONA CORPORATION COMMISSION
1200 W. Washington St.
Phoenix, AZ 85007

COPIES of the foregoing e-mailed this 26th day of November, 2024, to:

Tom Van Flein, General Counsel
Arizona Corporation Commission
1200 W. Washington Street
Phoenix, Arizona 85007
legal@azcc.gov
Counsel for Legal Division Staff

Directors Utilities Division
ARIZONA CORPORATION COMMISSION
1200 West Washington Street
Phoenix, Arizona 85007
utildivservicebyemail@azcc.gov

Glennie Reporting Services, LLC
1555 East Oranewood
Phoenix, Arizona 85020
admin@glennie-reporting.com

J. Matthew Derstine
Snell & Wilmer, L.L.P.
One East Washington Street
Suite 2700
Phoenix, AZ 85004
mderstine@swlaw.com

Alysha Y. Gilbert
SALT RIVER PROJECT AGRICULTURAL
IMPROVEMENT AND POWER DISTRICT
P.O. Box 52025, PAB381
Phoenix, AZ 85072-2025
alysha.gilbert@srpnet.com
Attorneys for Salt River Project Agricultural Improvement and Power District

///

1 Michelle De Blasi
2 Law Office of Michelle De Blasi
3 7702 East Doubletree Ranch Road, Ste. 300
4 Scottsdale, Arizona 85258
5 *Attorney for Intervenor Banner Health*

6 /s/ Tod Brewer
7 CEC 239

8
9
10
11
12
13
14
15
16
17
18
19
20
21
22
23
24
25
26
27
28

Exhibit A

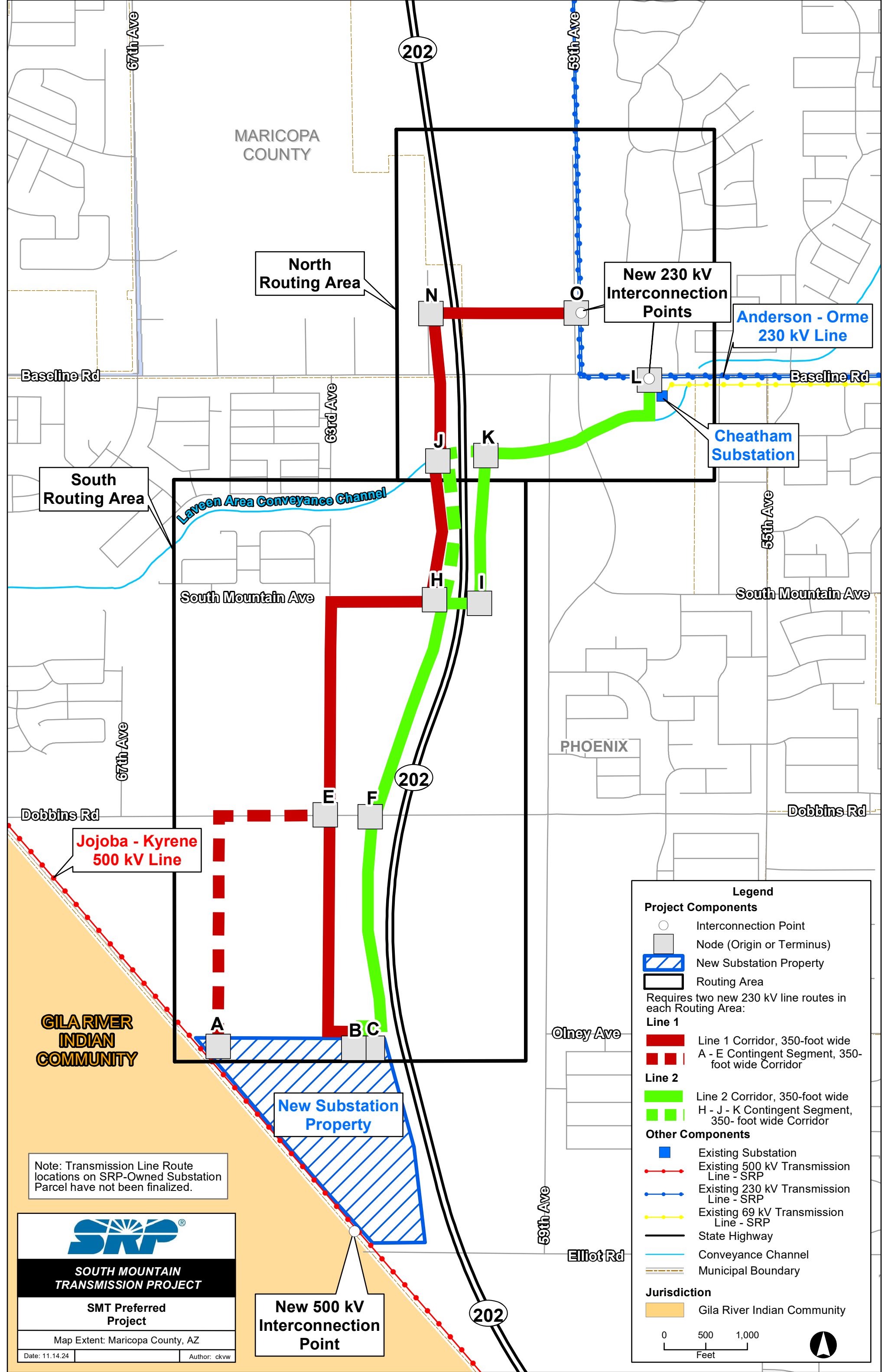

North Routing Area

South Routing Area

New 230 kV Interconnection Points

Anderson - Orme 230 kV Line

Cheatham Substation

Laveen Area Conveyance Channel

Jojoba - Kyrene 500 kV Line

New Substation Property

New 500 kV Interconnection Point

Legend

Project Components

- Interconnection Point
- Node (Origin or Terminus)
- ▨ New Substation Property
- ▭ Routing Area

Requires two new 230 kV line routes in each Routing Area:

Line 1

- ▬ Line 1 Corridor, 350-foot wide
- ▬ A - E Contingent Segment, 350-foot wide Corridor

Line 2

- ▬ Line 2 Corridor, 350-foot wide
- ▬ H - J - K Contingent Segment, 350-foot wide Corridor

Other Components

- Existing Substation
- Existing 500 kV Transmission Line - SRP
- Existing 230 kV Transmission Line - SRP
- Existing 69 kV Transmission Line - SRP
- State Highway
- Conveyance Channel
- Municipal Boundary

Jurisdiction

- Gila River Indian Community

0 500 1,000 Feet

Note: Transmission Line Route locations on SRP-Owned Substation Parcel have not been finalized.



SOUTH MOUNTAIN TRANSMISSION PROJECT

SMT Preferred Project

Map Extent: Maricopa County, AZ

Date: 11.14.24 Author: ckvw