

KEYNOTES

1. PERIMETER CEILING ANGLE TRIM
2. VERTICAL HANGER WIRES AT 4'-0" O.C. EACH WAY.
3. CROSS - RUNNER.
4. MAIN RUNNER AT 4'-0" O.C.
5. LATERAL BRACING WIRE. LOCATE BRACING ON MAIN RUNNER

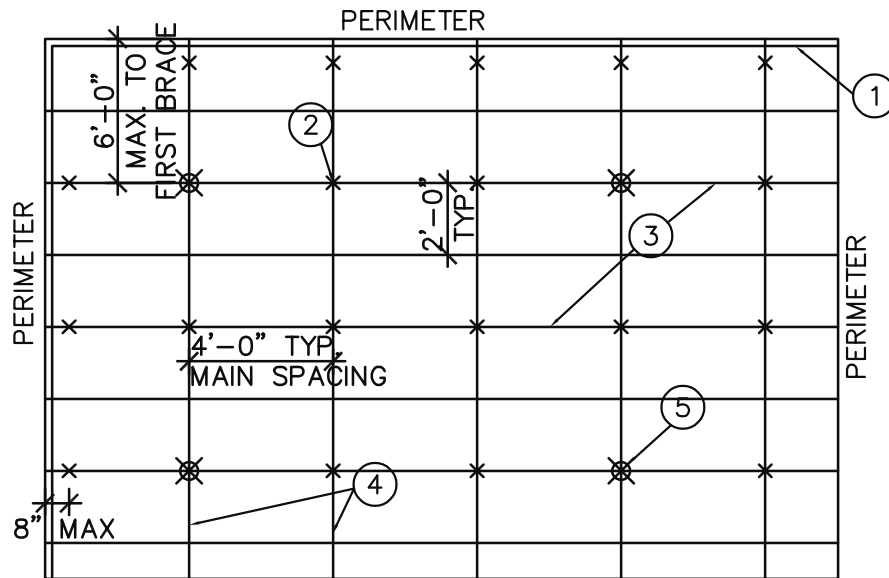

TYPICAL CEILING FRAMING PLAN VIEW

REV. NO. 001

REV. DATE : 08-27-20

DRAWN BY : NBS

DWG. NO.

AC-09

SCALE : NTS